



Part 8PJ052MINI-H: D8R - 40 GPM Mini Maintenance Kit



This kit contains:

(1) 8PJ008	Plunger and Plunger Seal
(1) 8PJ018	Upper Check Valve Assembly
(1) Silicone	DOSA-LUBE



2090 Sunnydale Blvd.
Clearwater, FL 33765
1-800-523-8499 • 1-727-443-5404
www.dosatronusa.com

Kit Contents:

8PJ008:
Plunger and
Plunger Seal



8PJ018:
Upper Check
Valve Assembly



DOSA-LUBE:
Silicone



Use **Dosa-Lube** on
specified parts only.



CAUTION: Parts may contain concentrated chemicals. The use of Proper Protective Equipment is recommended when performing maintenance.

Instructions

(Parts included in kit noted in blue)

Disassembly

1. Unscrew the suction hose nut (PDI057) and remove the suction hose.



2. Unscrew the bell housing (8MP003) and pull the piston assembly (8PC001) from the bottom of the unit straight out.

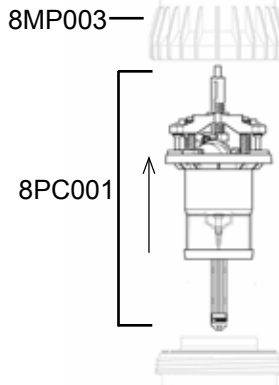

3. From the lower part of the piston assembly (8PC001) unscrew the white plunger assembly (8PJ008) and discard.

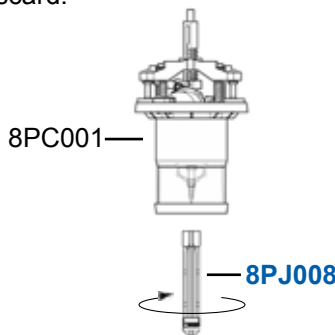

4. Unscrew the upper middle nut and pull the injection stem assembly (8CD031) out from the body of the unit.

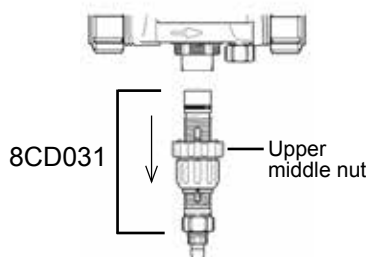

5. From the injection stem assembly (8CD031), unscrew the check valve nut (PDI056) and remove the check valve assembly (PDI006) by pulling straight down.

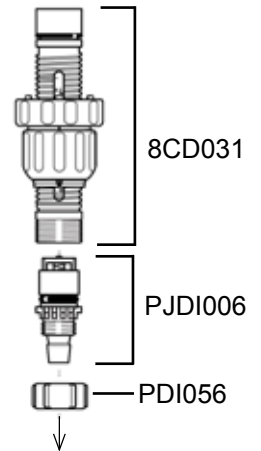

NOTE: If the upper check valve assembly (8PJ018) is stuck inside the white stem (8CD031), insert the eraser side of a pencil in the top of the white stem and push the upper check valve (8PJ018) out.

6. From the check valve assembly (PDI006), remove the upper check valve assembly (8PJ018) and discard this part.

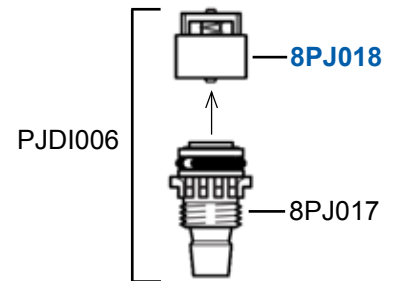

NOTE: Reassembly instructions on back.

Reassembly

7. Using the **Dosa-Lube** provided in the kit, rub a small amount onto the check valve barb o-ring (20J002), and place the new upper check valve assembly (**8PJ018**) on top of it.

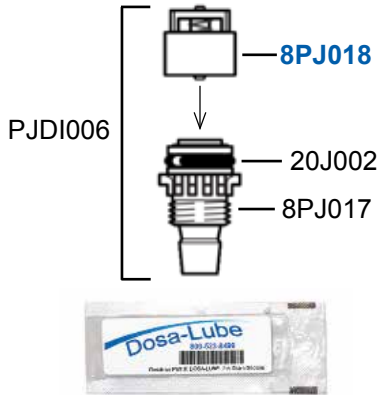

NOTE: Do not apply **Dosa-Lube** inside the check valve.

8. Reposition the check valve assembly (PJD1006) back into the bottom of the white injection stem (8CD031) and screw the check valve nut (PDI056) back on.

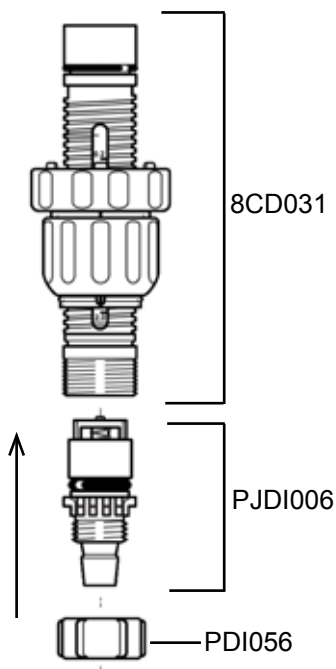

9. Apply a small amount of **Dosa-Lube** onto the injection stem assembly o-ring (8J026), then reinsert the injection stem assembly (8CD031) back into the bottom of the unit with the scale facing forward. Screw back the upper middle nut making sure the keys line up with the notches on the threaded diffuser nut (8P119U).

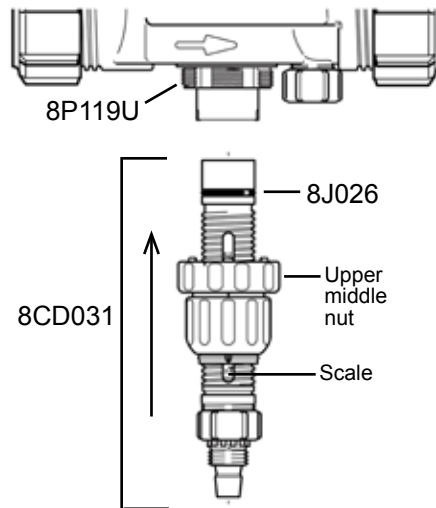

10. Take the new plunger assembly (**8PJ008**) and screw it back onto the end of the piston assembly (8PC001).

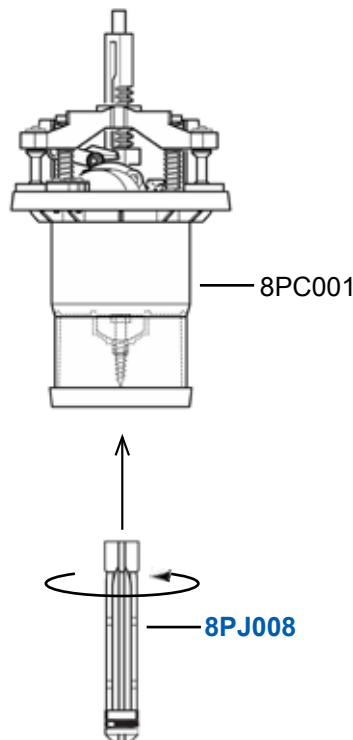

11. Take the whole piston assembly (8PC001) and reinsert it back into the body. Apply **Dosa-Lube** on bell housing o-ring (8J015). Screw the bell housing (8MP003) back on.

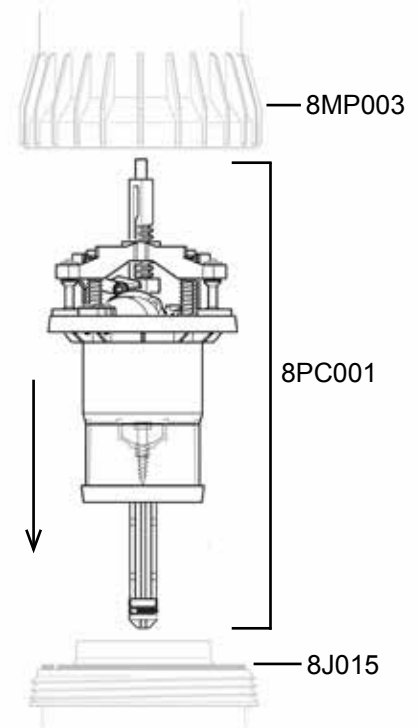

12. Cut 1" off from the top of the suction hose to ensure a tight fit, make sure to cut in a straight line. Attach the hose and the hose nut (PDI057) back to the unit.

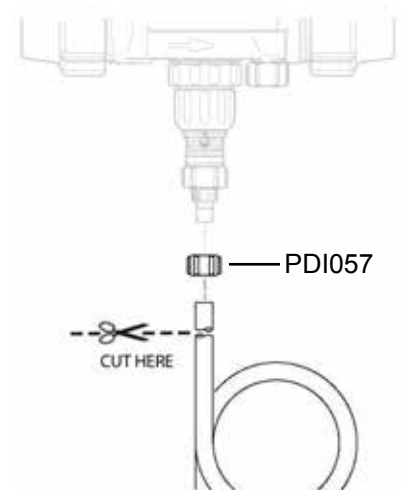

! Don't forget to reset your injection rate to the proper ratio.