



Part PJ117MINI-H: D25F1 - 11 GPM D25RE2 - 11 GPM

Instructions for the D25RE2
on the back

Mini Maintenance Kit

This kit contains:

(1) J009	Plunger seal
(1) MPDI122	Check valve assembly
(1) J051	Check valve seal
(1) Silicone	DOSA-LUBE



GENUINE
DOSATRON
PARTS

2090 Sunnydale Blvd.
Clearwater, FL 33765
1-800-523-8499 • 1-727-443-5404
www.dosatronusa.com

Kit Contents:

MPDI122: Check valve assembly



DOSA-LUBE: 2.5 grams silicone



Use **Dosa-Lube** on specified parts only.

J051: Check valve seal



J009: Plunger seal



STOP **CAUTION:** Parts may contain concentrated chemicals. The use of Proper Protective Equipment is recommended when performing maintenance.

! To remove seals easily without tools, squeeze on either side to raise the seal, then slide it over the groove. Using sharp tools could damage the plunger.

Instructions for the D25F1

(Parts included in kit noted in blue)

Disassembly

1. Unscrew suction hose nut (P153) and remove suction hose. Using a #2 Phillips screwdriver remove the four screws (M101) at the base of the unit. Remove collar (M079).

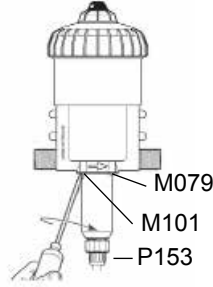

2. Pull the injection stem assembly (P439) down.

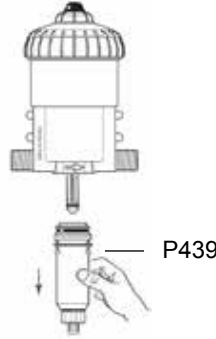

3. Remove old plunger seal (J009) and replace with new seal in kit. If the white cone (PDI568) falls out remember to reposition.

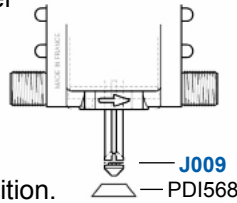

4. Unscrew the check valve barb (P169). Remove the check valve seal (J051). If the seal isn't visible at the end of the injection stem (P439), look inside the check valve barb (P169). Carefully pry the check valve assembly (MPDI122) out of the injection stem (P439) watching out not to damage the lower end of the injection stem.

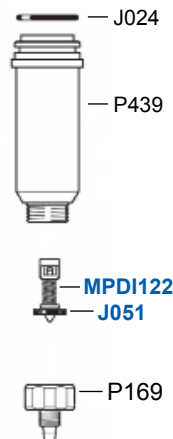

5. Insert the new check valve assembly (MPDI122) into the injection stem (P439) with the cone pointing out. Push the new check valve assembly as far as possible into the stem. Replace the check valve seal (J051) into the check valve barb (P169) with the groove facing up. Hand tighten the check valve barb (P169) onto the injection stem (P439). Rub small amount of **Dosa-Lube** on the stem o-ring (J024).

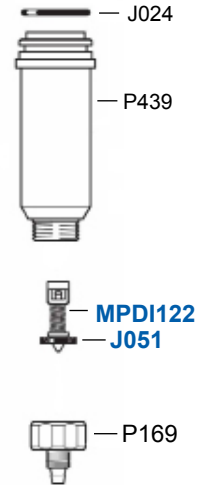

6. Insert the injection stem assembly into the lower housing. Align the metal retainer plate with the holes in the body and using a #2 Phillips screwdriver, carefully install the four screws.

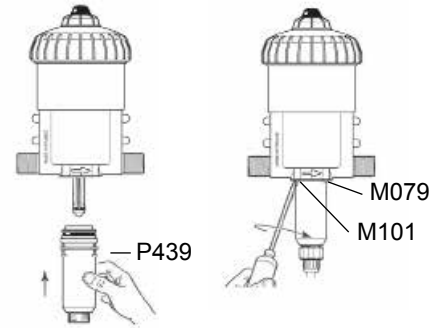

7. Cut 1" off from the top of the suction hose to ensure a tight fit, make sure to cut in a straight line. Reattach suction hose and tighten suction hose nut (P153).

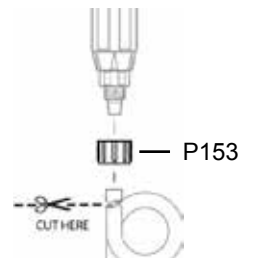



Part PJ117MINI-H: D25RE2 - 11 GPM D25F1 - 11 GPM

Instructions for the D25F1
on the back

Mini Maintenance Kit

This kit contains:

(1) J009	Plunger seal
(1) MPDI122	Check valve assembly
(1) J051	Check valve seal
(1) Silicone	DOSA-LUBE



2090 Sunnydale Blvd.
Clearwater, FL 33765
1-800-523-8499 • 1-727-443-5404
www.dosatronusa.com

Kit Contents:

MPDI122: Check valve assembly



DOSA-LUBE: 2.5 grams silicone



Use **Dosa-Lube** on specified parts only.

J051: Check valve seal



J009: Plunger seal



STOP CAUTION: Parts may contain concentrated chemicals. The use of Proper Protective Equipment is recommended when performing maintenance.

! To remove seals easily without tools, squeeze on either side to raise the seal, then slide it over the groove. Using sharp tools could damage the plunger.

Instructions for the D25RE2

(Parts included in kit noted in blue)

Disassembly

1. Unscrew suction hose nut (P153 or P150) and remove suction hose. Using a #2 Phillips screwdriver remove the four screws (M101) at the base of the unit. Remove collar (M079).

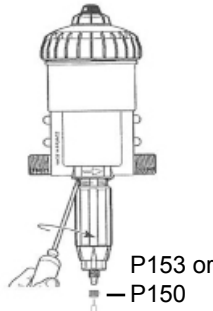

2. Pull the injection stem assembly (CD072) down.

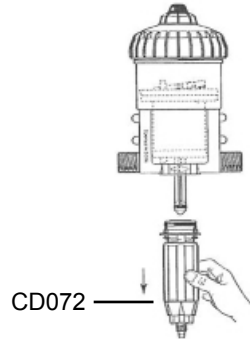

3. Unscrew the check valve barb (P169). Remove the check valve seal (J051) and discard. Unscrew the conical nut (P168), remove the anti-lock ring (P189) and carefully pry the check valve assembly (MPDI122) from the stem and discard.

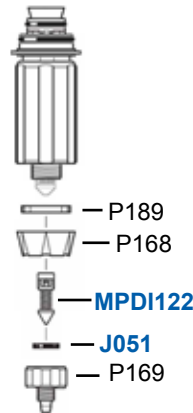

4. Remove the injection stem (PJ121) from the top of the injection sleeve (P165).

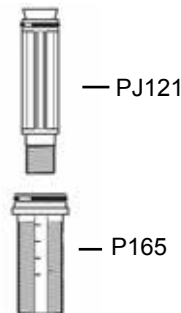

5. Insert the injection stem (PJ121) into the top of the injection sleeve (P165). Make sure that the long groove in the injection stem aligns with the tooth inside the injection sleeve.

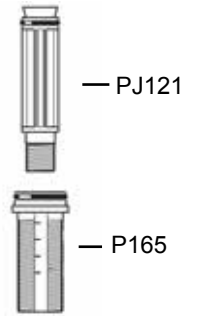

6. Reinstall the anti-lock ring (P189) and the conical nut (P168). Insert the new check valve assembly (MPDI122) into the injection stem with the cone pointing out, push it as far as possible into the stem. Position the check valve seal (J051) into the check valve barb (P169) with the groove facing up. Hand tighten the check valve barb. Set aside.

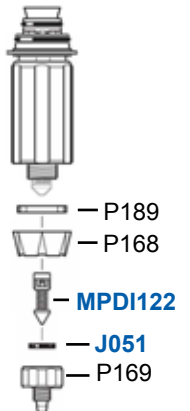

7. Remove and replace the plunger seal (J009). Reinsert injection stem assembly (CD072) into the body.

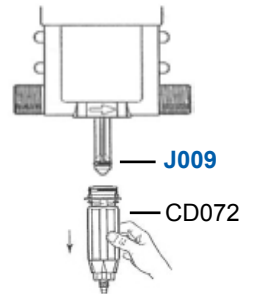

8. Align the metal collar (M079) with the holes in the body. Install the four screws using a #2 Phillips screwdriver.

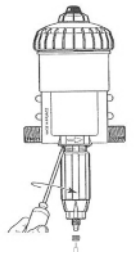

9. Cut 1" off from the top of the suction hose to ensure a tight fit, make sure to cut in a straight line. Slide suction hose nut (P153) onto the suction hose, reattach suction hose and tighten suction hose nut (P153).

