



**DOSATRON**<sup>®</sup>

WATER POWERED DOSING TECHNOLOGY

## Nutrient Delivery System Models

MODEL NUMBER	MODEL
D25RE09VFBPHY	
D14MZ2VFBPHY	
D14MZ10VFBPHY	
D14MZ3000VFBPHY	

# Nutrient Delivery System

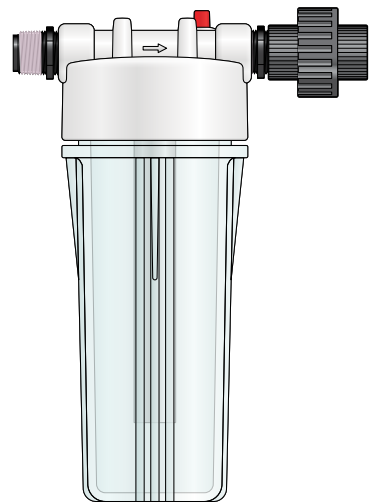

**NOTE:** Installation illustrations are to be used as a reference guide only.

## Mixing Chamber Kit Part #: HYKMC34



2090 Sunnysdale Blvd. • Clearwater, FL 33765  
1-800-523-8499 • [www.dosatronusa.com](http://www.dosatronusa.com)

Mixing Chamber Kit includes parts listed.  
Dosatron injector sold separately.



# Mixing Chamber Kit

## Step-by-Step Assembly Instructions

1

Wrap **Teflon®** tape\* on both ends of the two **Nipples**.

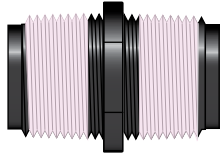

2

Insert the **Nipples** into each side of the **Mixing Chamber**.

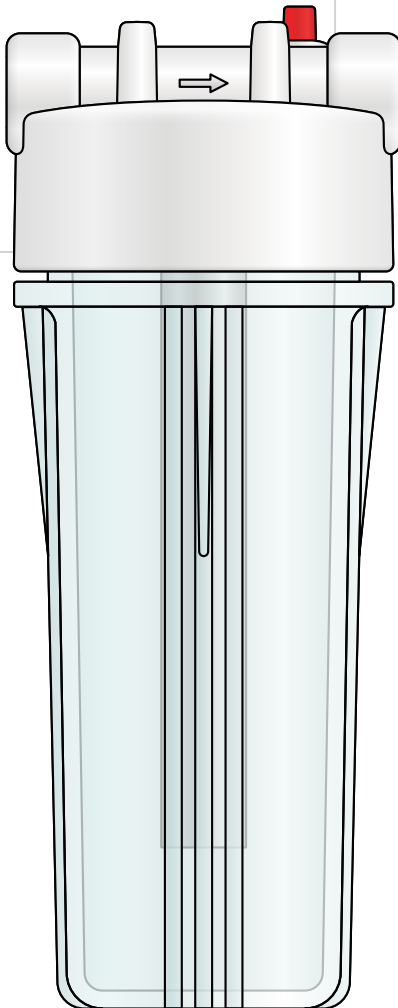

3

With the arrow on the **Mixing Chamber** pointing in the direction of the water flow, install the **Union** onto the **Nipple** of the outlet side of the **Mixing Chamber**.

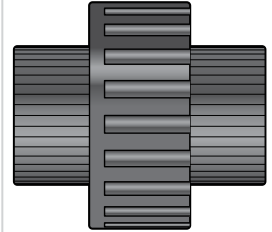

### Kit Includes:

- 1 - Mixing Chamber
- 1 - Union
- 2 - Nipples
- 1 - Roll of Teflon® tape

Dimensions: 9" wide x 15" high

\* Wrap 3-4 turns of the pink Teflon® tape included in your kit. If you are using white Teflon® tape, wrap 6-8 turns. To wrap, hold the part in your left hand and wrap the Teflon® tape clockwise.